



GreenCity

CONSTRUCTIONS
ISO 9001 : 2008 Certified Company

RERA NO. PRM/KA/RERA/1251/310/PR/190809/002754



— OC obtained —



Green City Constructions is an innovative, energetic, vibrant organization with its focus on creating superbly-crafted living spaces that are designed with the aim of integrating opulence to impeccable aesthetic taste and design. Our driving force is our out-of-the-box, innovative ideas towards construction and design, flowing from the fount of our team of experts, each dedicated to the goal of being the creator of a space that is both beautiful and pragmatic, that is a fantasy as well as a real home.

Our overarching objective is to make splendor and luxury accessible. With this in mind, every one of our projects consists of precision construction where finesse is tempered with functionality, where practicality meets dreamscapes and castles are brought down from the air to be experienced and enjoyed.



At a time of exponential growth in Bengaluru, GreenCity Eutopia offers one-of-its-kind lush, sprawling, superior residential spaces:
An opportunity that will never again present itself!

A stunning creation of ultra premium condominiums located in the heart of the city, Eutopia boasts a brilliant futuristic design, with world class infrastructure and facilities, and a plethora of modern, state-of-the-art amenities.

Come home to the WOW factor!



What could possibly give you that **'WOW'** feeling?!

- Exceptional architecture
- Distinctive, superior amenities
- Chic aesthetics
- Extraordinary features & finishes
- Stunning panoramic landscapes
- Incredibly competitive prices

✓ All of the above

Eutopia's landscapes reflect an artist's sensibility, with personal touches and an overall harmony that charms the eye at every turn

A routine day in our courtyard could involve a walk in our calming Zen Gardens, or maybe a refreshing stroll through the herb garden, or, indeed, a soothing massage for your feet at our acupressure walk!

Where else would you get such wonderful locales to wind down at the end of a hectic day, where even just reading a paper or book, or watching children play to the tune of songbirds becomes a moving, transcendental experience.

Leave the concrete jungle behind and step into the serene embrace of this urban sanctuary.



Block A

Block A 201
Super Built-up Area 2305 Sq. Ft

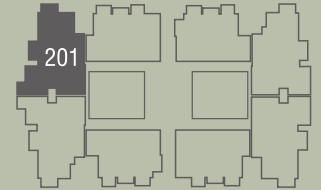
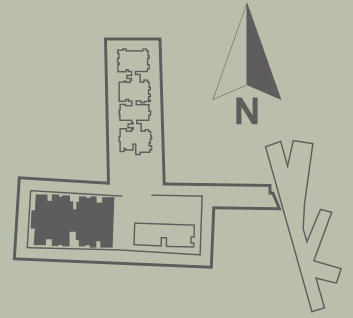

Block A 202
Super Built-up Area 1900 Sq. Ft

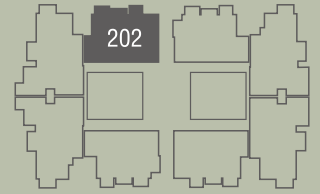
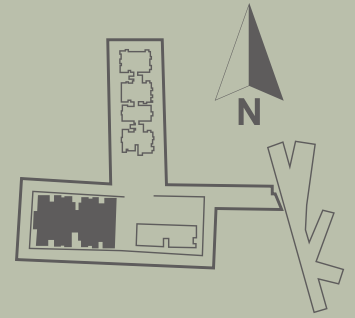



Block A 203
Super Built-up Area 1850 Sq. Ft

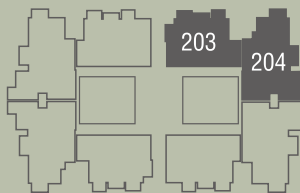
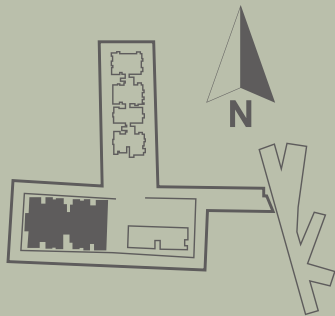

Block A 204
Super Built-up Area 2225 Sq. Ft





Block A 205
Super Built-up Area 2255 Sq. Ft

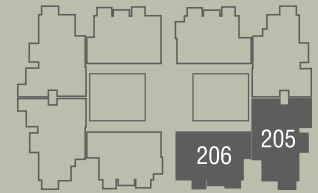
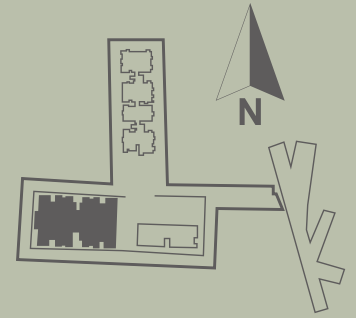

Block A 206
Super Built-up Area 1900 Sq. Ft



Block A 207
Super Built-up Area 1850 Sq. Ft



Block A 208
Super Built-up Area 2270 Sq. Ft

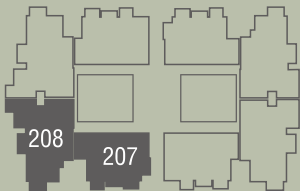
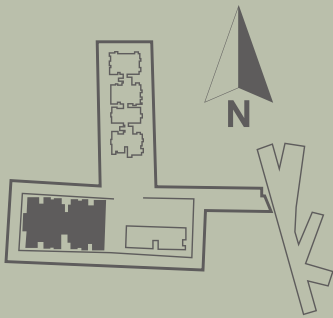

BLOCK B



BLOCK B 201
SUPER BUILT AREA 1785 SQ.FT



BLOCK B

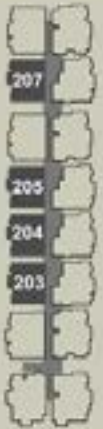

BLOCK B 203,204,205,207
SUPER BUILT AREA 1545 SQ.FT



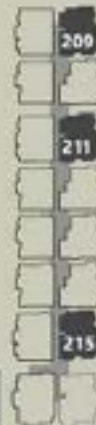

BLOCK B

BLOCK B 209,211,215
SUPER BUILT AREA 1750 SQ.FT





BLOCK B

BLOCK B 210, 212, 213, 214
SUPER BUILT AREA 1545 SQ.FT



SPECIFICATION

STRUCTURE

RCC frame structure with masonry partitions.

Internal Masonry : Good quality solid blocks provided with sand face plaster and putty, corners protected with corner beads

External Masonry : Good quality solid blocks provided with sand face plaster, all feature walls finished with aluminium grooves at regular intervals.

Paint: All internal paint shall be in Acrylic Emulsion and External Paint shall be provided with texture finish.

Fire escape staircase : RCC stairs encased in Granite from ground to all floors.

FLOORING AND DADO

Living & Dining : customers choice for Light Emperador / Botticino -Italian marble.

Kitchen : Black pearl granite with lapethoro finish.

Master Bedroom : High quality wooden flooring.

Master Bathroom : 12"-24" designer wall tiles up to false ceiling.

Children's Bedroom : High quality wooden flooring.

Children's Bathroom : 10"-24" designer wall tiles up to false ceiling.

Guest Bedroom : High quality wooden flooring.

Guest Bathroom : 10"-24" designer wall tiles up to false ceiling.

SANITARY & PLUMBING

Water Closets : Western style, porcelain EWC of Duravit / other equivalent make in all bathrooms.

Flushing : Water saving dual flush concealed cistern with wall plate of Duravit / other equivalent make.

Health Faucets : Health faucets of Duravit / other equivalent make in all bathrooms.

Wash Basins : Porcelain counter top wash basins of Duravit / other equivalent make in all bathrooms, with a granite vanity counter.

Kitchen sink : Single bowl stainless steel sink with drain board of reputed make.

Bathtubs : Bath tub of Oyster make in each Master bath.

Shower Cubicles : Shower glass curtain in master bath and all other bathrooms shall be provided.

Faucets : All faucets shall be in CP fittings of Grohe make.

Bathroom Accessories : Towel rings, toilet paper holders - all of reputed make.

Plumbing : All water supply lines & drainage lines will be in CPVC pipes. The sewage lines will be in PVC.

ELECTRICAL

Wiring : All wiring shall be of KEI / Havells or equivalent make.

Earthing : 1.0 & 1.5sqmm Copper wire shall be used for earthing using the loop system. One Earth Leakage Circuit Breaker and MCB shall be provided in each apartment. Lightning arrester and earth pits shall be provided with separate earth point for the elevators..

Switches : All switches are Siemens/Havells make.

Light Fixture: In each apartment light fixtures are occupiers scope and the common area lighting will be provided.

DOORS & WINDOWS

Frames : Main door frame shall be in teak wood and other doors shall have beech wood frames.

Door Shutters : 40mm thick single shutter in solid teak for main door and other doors of 32mm thick.

Finish : The internal door shutters and frames will be PU finish.

Hardware: All hardware shall be in stainless steel brush finished.

Windows : All windows are of 3 track UPVC make with 6mm toughened glass for french windows / normal glass for all other windows.

Mosquito Mesh : Mosquito mesh will be provided to all windows.

UTILITIES & SERVICES

Power : KEB Power of 6 KW per apartment shall be provided

Back-up Power : 3KW Back-up power shall be provided to each unit. 100% back up to the common area lighting, pumps and motors etc.

Water : A water treatment plant shall be provided for supply of portable water to the units

Rainwater Harvesting : Percolation pits shall be provided for rainwater harvesting

Elevators : 2 nos. 10 passenger elevators and 1 no. 15 passenger elevator (to be used as freight elevator) shall be provided with automatic doors. Passenger lift will be finishes with SS finish and Freight elevator will be finished with powder coat inside the cabins. Elevators shall be provided with multi-beam sensors for door operation and down collective system

FACILITIES & AMENITIES

Multipurpose Hall : Multipurpose hall for parties / functions with air-condition system.

Swimming Pool : A 4' deep swimming pool with a separate paddle pool for kids.

Gym : Gym with equipment.

Steam and Sauna : Separate steam and sauna rooms for Ladies and gents.

Games Area : Games room with board games equipment.

Games : Squash Court, Badminton court, Table Tennis, Skating rink, Billiards, Basketball, Wall Climbing shall be provided in the club house area. Squash courts will be finished with sports hardwood flooring supported by shock pads.

LANDSCAPING IN COMMON AREAS

Soil : Good quality red soil and sand mixture with manure shall serve as the base layer for landscaping.

Irrigation : Sprinklers and a drip irrigation system shall be provided for landscaped areas at podium level.

Soft Landscaping: Grass, shrubs and bamboo etc. shall be provided and all garden areas shall be completely landscaped.

Lobby : height entrance lobby finished with granite flooring.

Water Body : Cascading water feature with lighting shall be provided.

Landscape Podium : Lush green Landscaped podium with seating and walkways.



AMENITIES

GreenCity believes that the science behind a successful living revolves around fresh ideas, stimulating research, accurate planning and the flair towards its execution. A space that is devised with the same level of commitment, bringing into life the Science of Real Estate, while keeping innovation as its partner, GreenCity ventures out into a world of limitless possibilities in delivering not just a living space but a lifestyle that only a few are entitled to.



Sport

Badminton
Table Tennis
Skating rink
Basketball
Wall Climbing
Putting Green

Health

Meditation space
Acupressure Walk
Covered pool
Gym
Yoga hall
Jogging
Nordic Walking track

Entertainment

Barbeque point
Amphitheatre
Multi-purpose hall

Relaxation

Rock garden
Herbal garden
Zen & Bonsai garden
Children's park

Value Adds

Business center
Centralized gas connection
Library
Advanced security systems
Ample parking
Grand entrance plaza

- 1 - CLUBHOUSE
 - Swimming Pool
 - Business Lounge
 - Gymnasium
 - Banquet Hall
 - Badminton Court
 - Indoor Games
- 2 - SKATING RINK
- 3 - BASKET BALL COURT
- 4 - RAPPLING WALL
- 5 - CHILDREN'S PARK
- 6 - ZEN GARDEN
- 7 - ROCK GARDEN
- 8 - BONSAI GARDEN
- 9 - HERBAL GARDEN
- 10 - COMMUNITY CORNER
- 11 - OPEN AIR THEATER



LIVING AREA



EXCLUSIVE
GIFT*



DINING



FALSE
CEILING



BED ROOM

Best Deals by Interior Partner

WALLS 'N' FLOOR DECOR

☎ 82778 89355

🌐 www.wallsnfloordecor.com

This brochure is conceptual in nature, is by no means a legal offering.
The promoters have the right to change, alter, delete or add any specifications or elevation mentioned herein.



Architects:
Adithya G Kashyap
Principal Architect
Architecture Continuous
www.architecturecontinuous.com

Structural Engineers:
Eco Consultants

Fire and PHE Consultants:
Prism Consultants

Electrical Consultants:
Alpha Engineers



GreenCity Constructions Pvt Ltd
Plot # 9, 16th Main, BTM 2nd Stage
Bangalore 560076 INDIA
web : www.greencityconstructions.com



Exclusive Marketing Team
Liveinn Buildtech Pvt Ltd
8880594444